

# IPOTESI DI DISTRIBUZIONE INTERNA DEGLI SPAZI

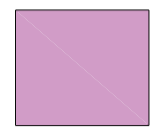

UNITA' R) SUP. LORDA = circa 208,66 mq.

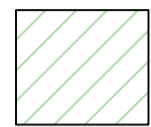

AMPLIAMENTO UNITA' R) SUP. LORDA = circa 279,52 mq.

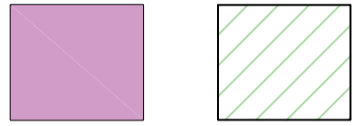

TOTALE UNITA' R) SUP. LORDA = circa 488,18 mq.

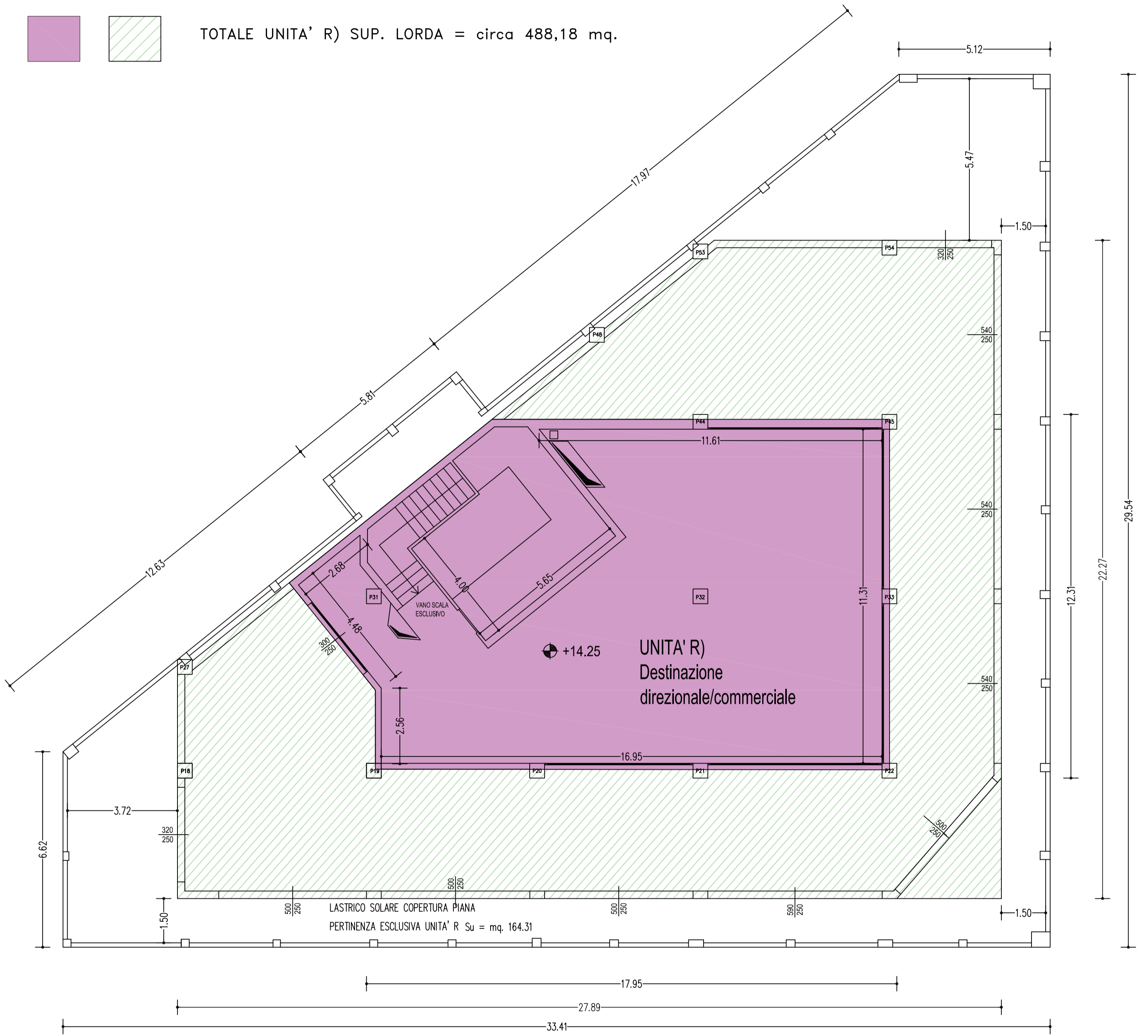

## Planimetria piano quarto

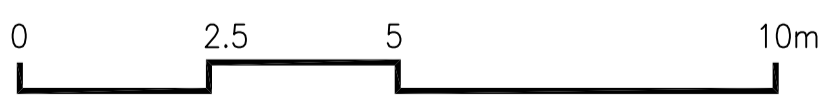

<b>COMUNE DI CREMA</b>	
COMMITTENTE: GERUNDIO CENTER S.r.l.	
REVISIONE	DATA
UBICAZIONE: Via Indipendenza angolo via Lago Gerundio	
DATI CATASTALI	
FG.21	MAP. 999
PROGETTO:	
VARIANTE AL PIANO ATTUATIVO "LAGO GERUNDO" APPROVATO IL 12/12/2005 DEL. 365/2005 E IN VARIANTE AL PGT VIGENTE	
Pianta Piano Quarto	
Stato di progetto	
TAVOLA	SCALA
<b>14</b>	1:100
	DATA
	12/17
Architetto Carlo Schira	
Via XX Settembre, 21 - 26013 CREMA (CR)	
Mobile - +39 339 1255217 e-mail: c.schiramail@gmail.com	